

I1

PREMA15D / 5017MC5 [DMM5017]

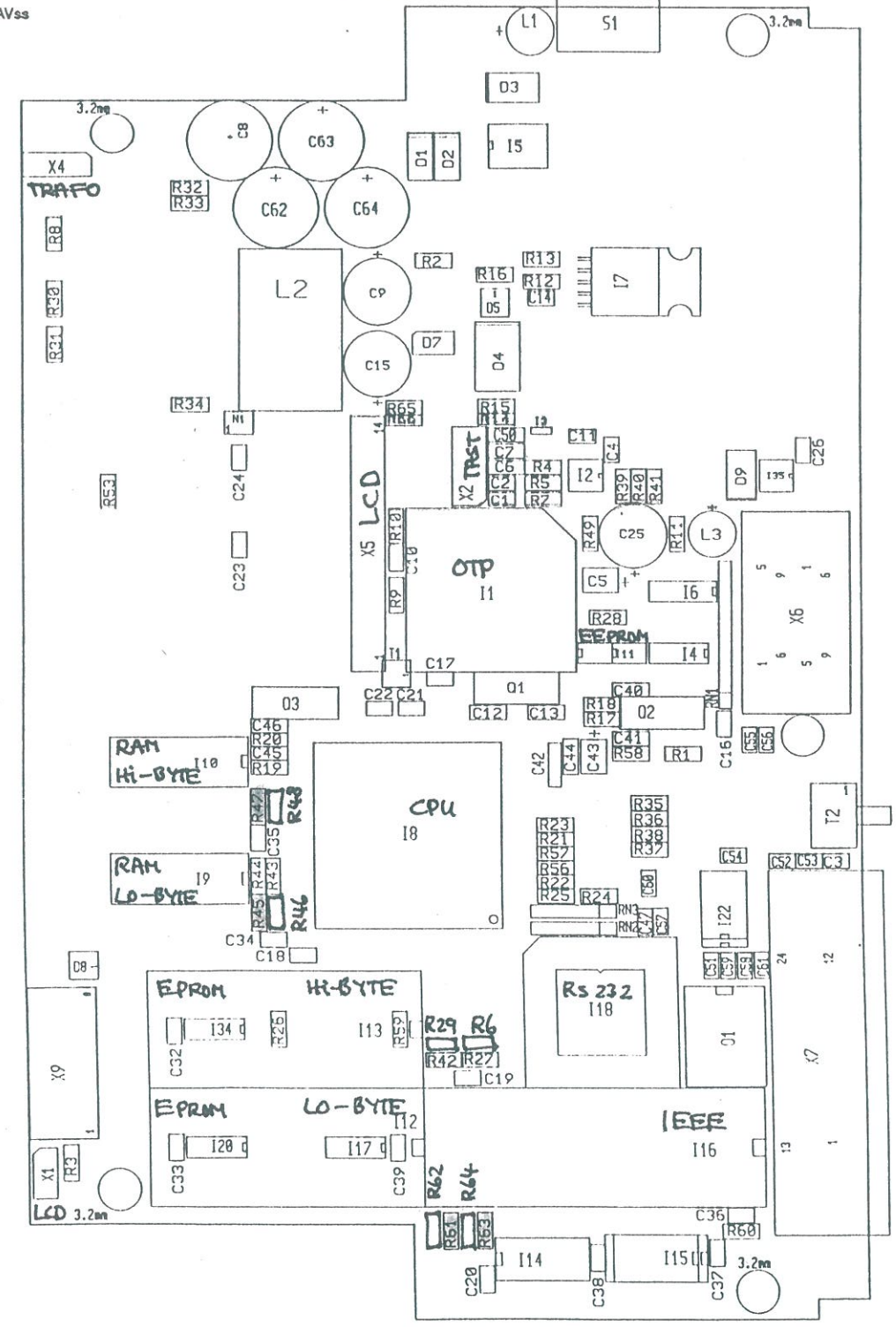

Bestückplan (1.00 17:07:96 PREMA15D)

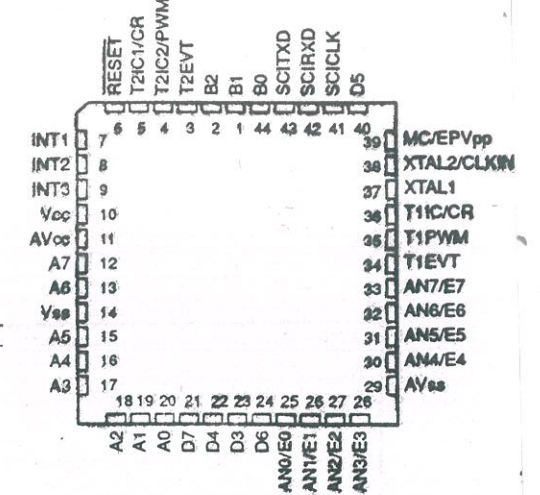
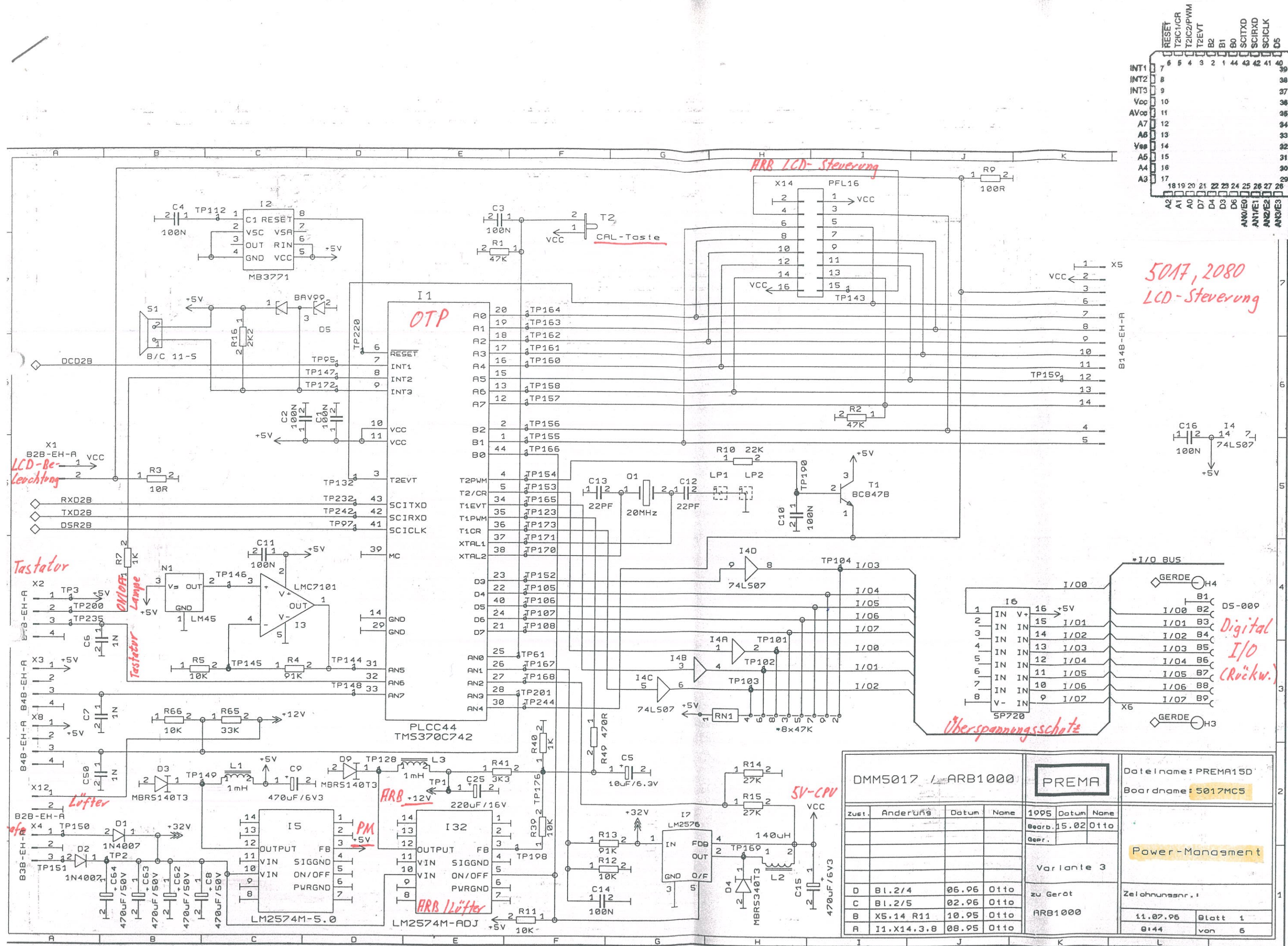

5017, 2080  
LCD-Steuerung

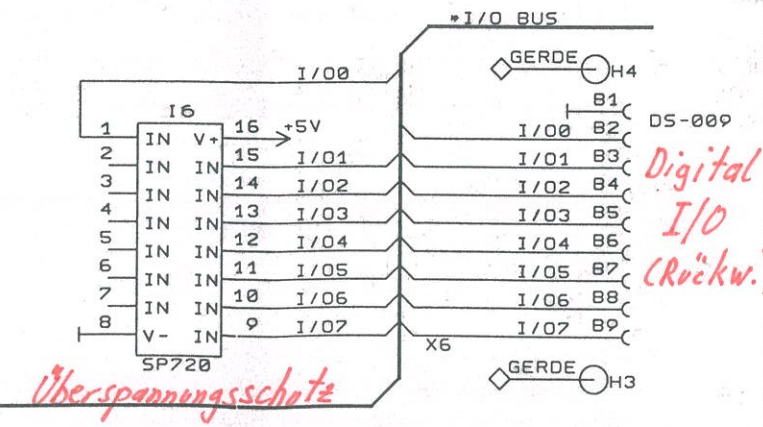
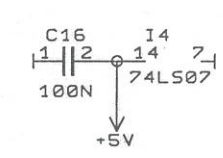

DMM5017 / ARB1000				PREMA		Dateiname: PREMA15D	
						Boardname: 5017MCS	
						Zu Gerat	
						ARB1000	
						Zelahnungsnr.:	
						11.07.96 Blatt 1	
						9:44 von 5	

zust.	Anderung	Datum	Name	1995	Datum	Name
				Bearb.	15.02	Otto
				Gepr.		
Variante 3						
D	Bl.2/4	06.06	Otto			
C	Bl.2/5	02.06	Otto			
B	X5.14 R11	10.95	Otto			
A	I1.X14.3.8	08.95	Otto			

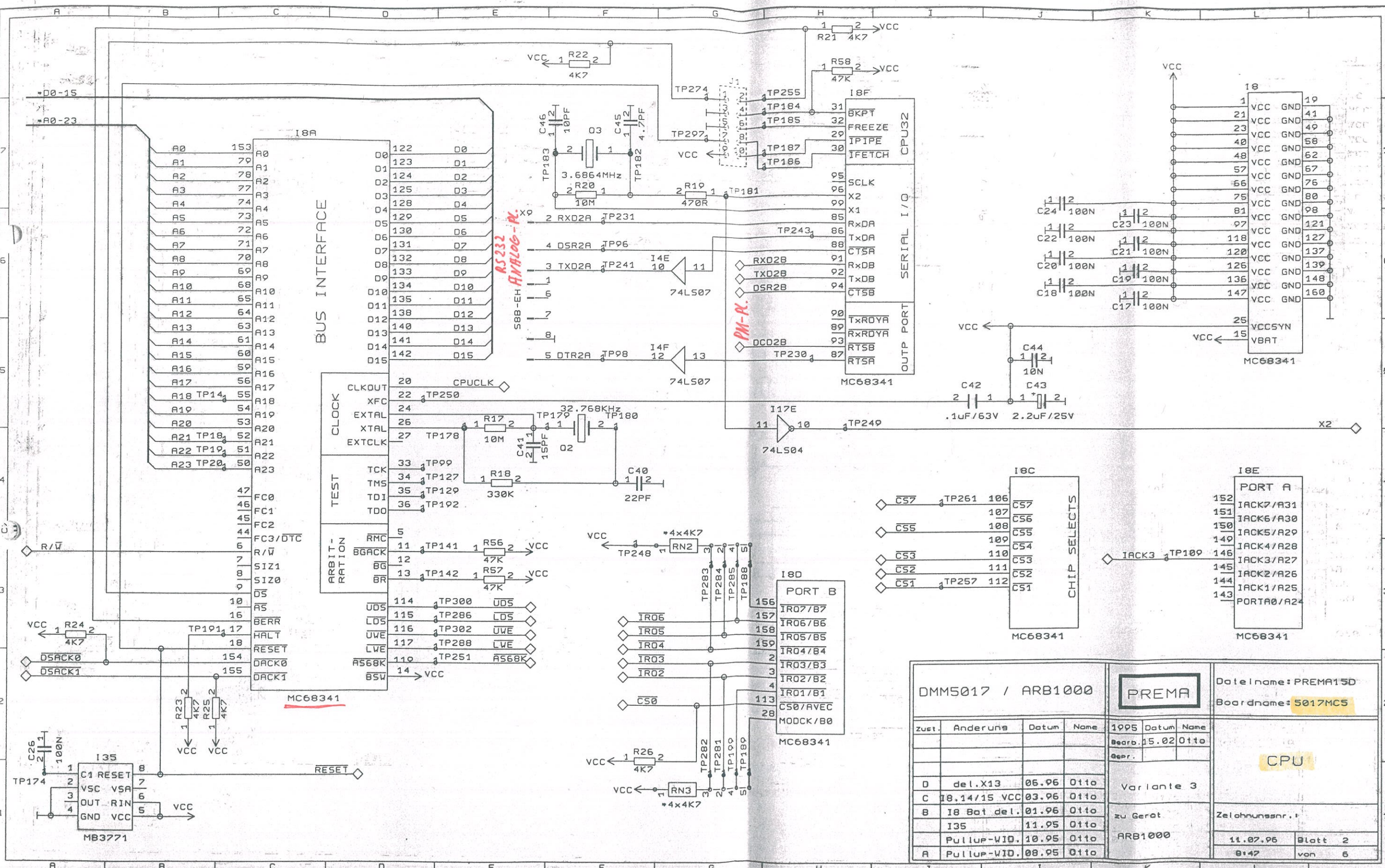

DMMS017 / ARB1000				PREMA		Dateiname: PREMA15D	
						Boardname: 5017MC5	
						CPU	
				Variante 3		Zelohnunsnr.:	
				zu Gerät		ARB1000	
				ARB1000		11.07.96 Blatt 2	
						8:47 von 6	

zust.	Anderung	Datum	Name
D	del.X13	05.96	Otto
C	I8.14/15 VCC	03.96	Otto
B	I8 Bat del.	01.96	Otto
	I35	11.95	Otto
	Pullup-WID.	10.95	Otto
A	Pullup-WID.	08.95	Otto

1995	Datum	Name
Bearb.	15.02	Otto
Gepr.		

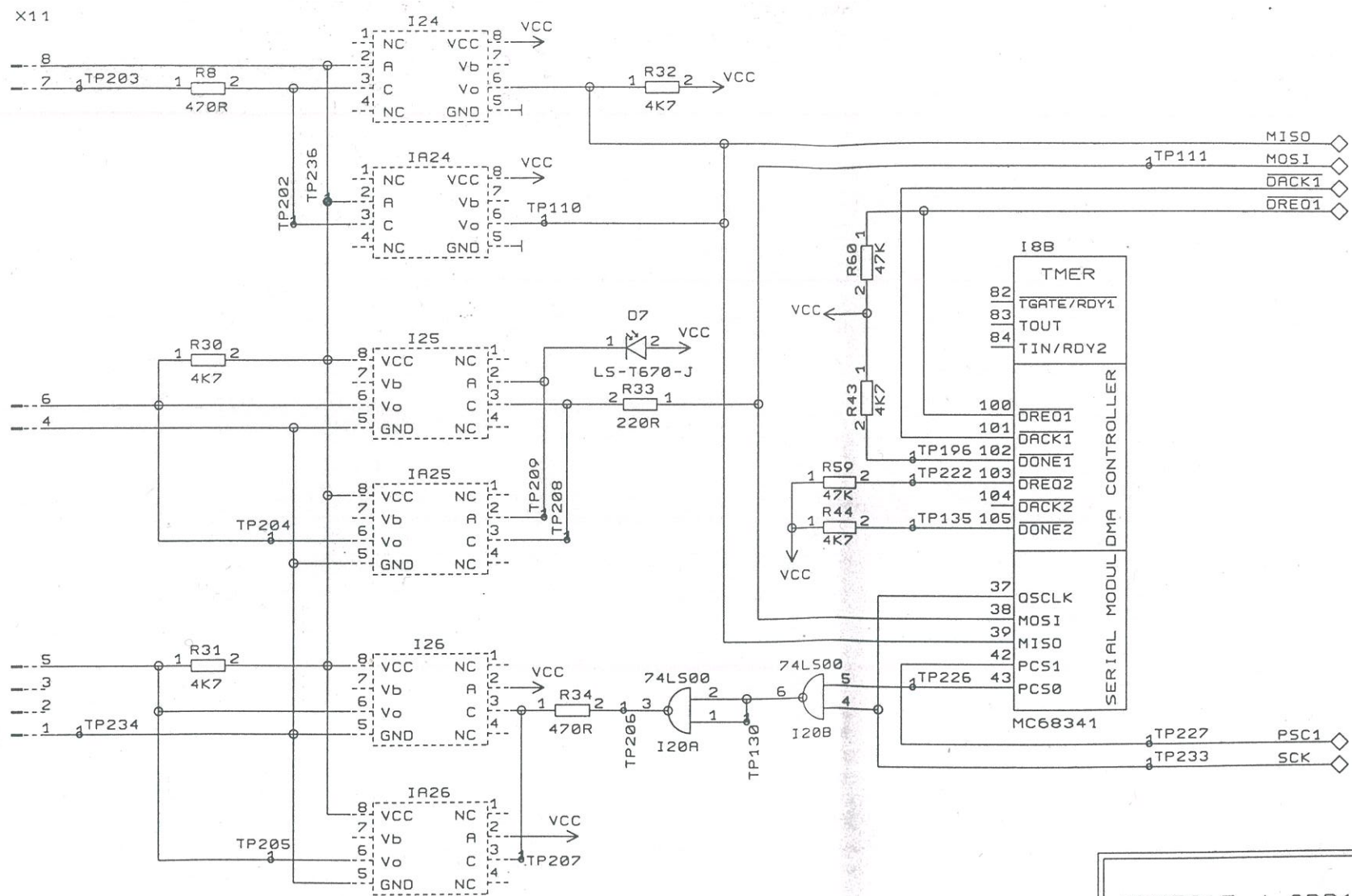

DMM5017 / ARB1000		<b>PREMA</b>		Dateiname: PREMA15D	
				Boardname: 5017MC5	
zust.		Anderung		Datum	
				Name	
				1995 Datum Name	
				Bearb. 15.02 Otto	
				Gepr.	
				Variante 3	
D		R30-33		06.96 Otto	
C		Bl.2/5		02.96 Otto	
B		Bl.1/2/4/5		11.95 Otto	
A		Bl.1/2/4/5		08.95 Otto	
				zu Gerät	
				ARB1000	
				Zeichnungsnr. 1	
				16.07.96 Blatt 3	
				13.22 von 6	

Opto-Koppler

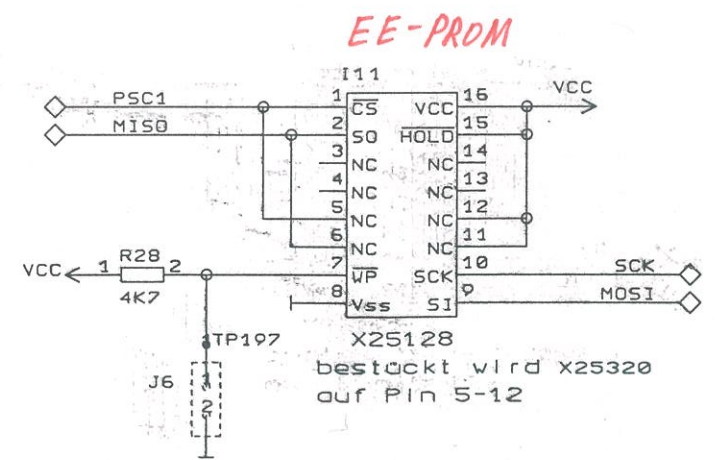
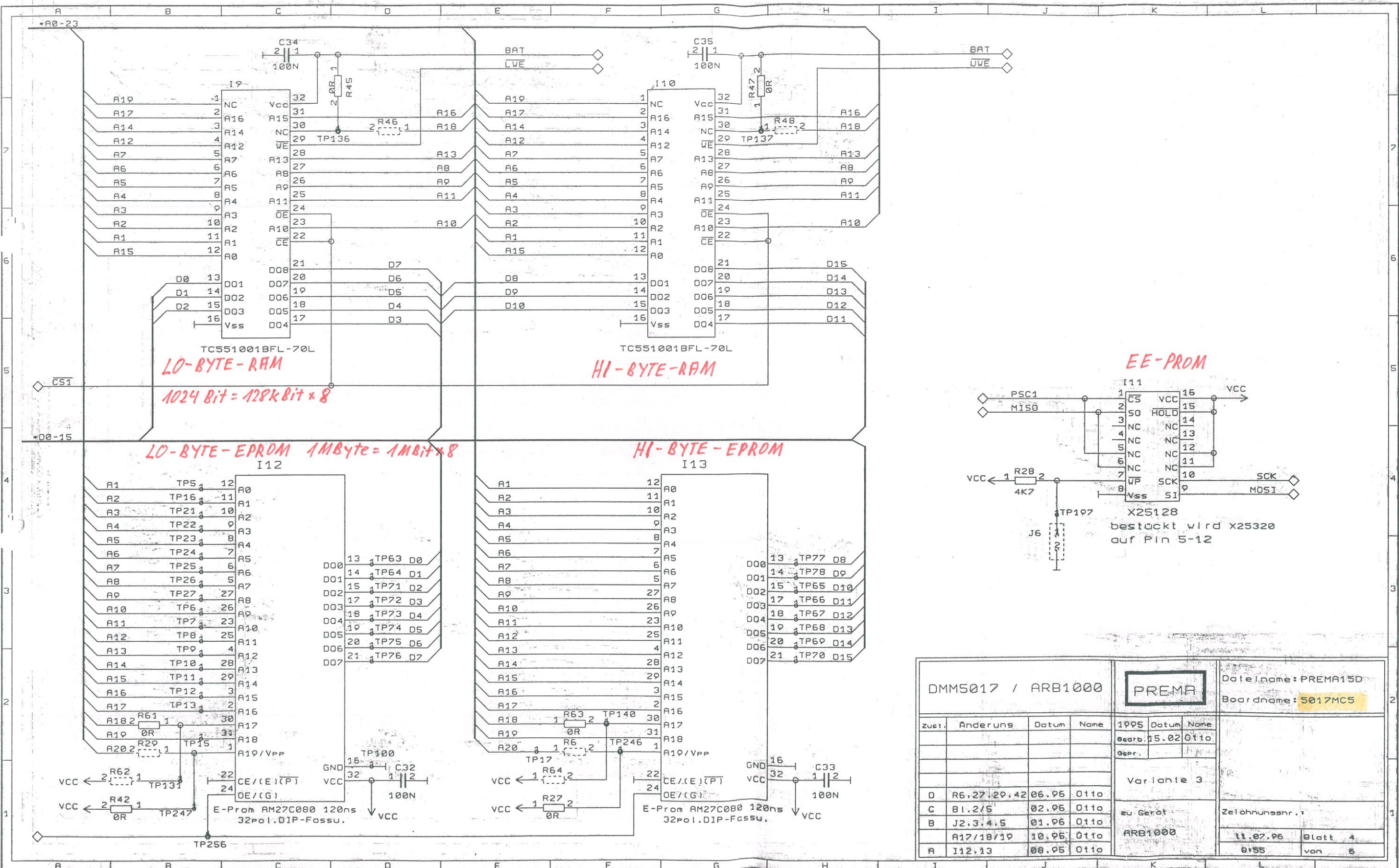

DMM5017 / ARB1000				PREMA		Dateiname: PREMA15D	
						Boardname: 5017MCS	
Zust.	Anderung	Datum	Name	1995	Datum	Name	
				Bearb.	15.02	Otto	
				Gepr.			
				Variante 3			
				zu Gerät		Zeichnungsnr.:	
				ARB1000			
D	R6.27.29.42	06.96	Otto			11.07.96 Blatt 4	
C	B1.2/5	02.96	Otto			0155 von 6	
B	J2.3.4.5	01.96	Otto				
	A17/18/19	10.96	Otto				
A	I12.13	08.96	Otto				

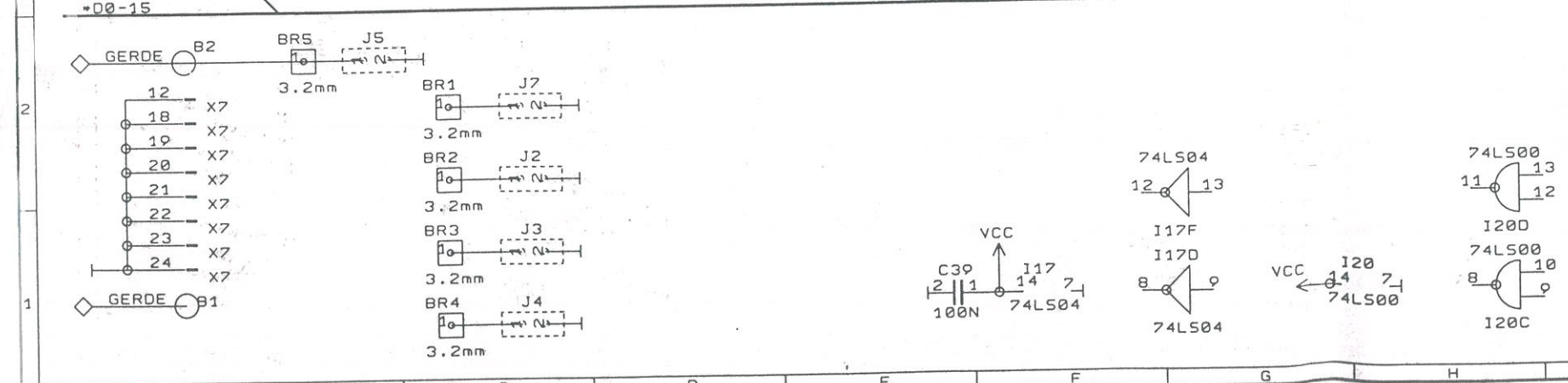
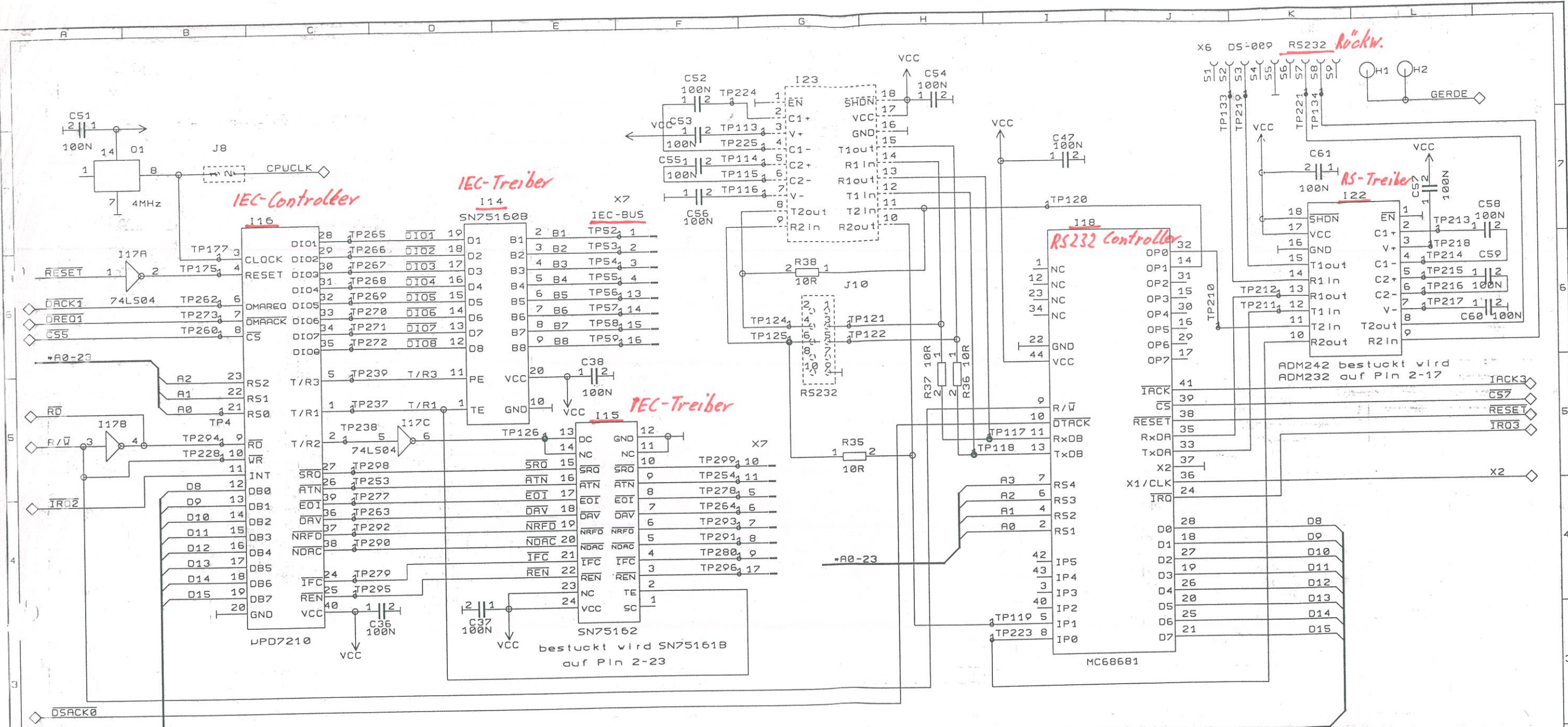

DMM5017 / ARB1000				PREMA		Dateiname: PREMA15D	
						Boardname: 5017MC5	
Zust.	Anderung	Datum	Name	1995	Datum	Name	
				Bearb.	15.02	Otto	
				Variante 3			
				zu Gerät		Zelohnungsnr.:	
				ARB1000			
D	B1.2/4	06.96	Otto				
C	I18.36/37	03.96	Otto				
B	I17.120.X7	01.96	Otto				
A	I17.20	08.95	Otto				
				11.07.96		Blatt 5	
				0:59		von 6	

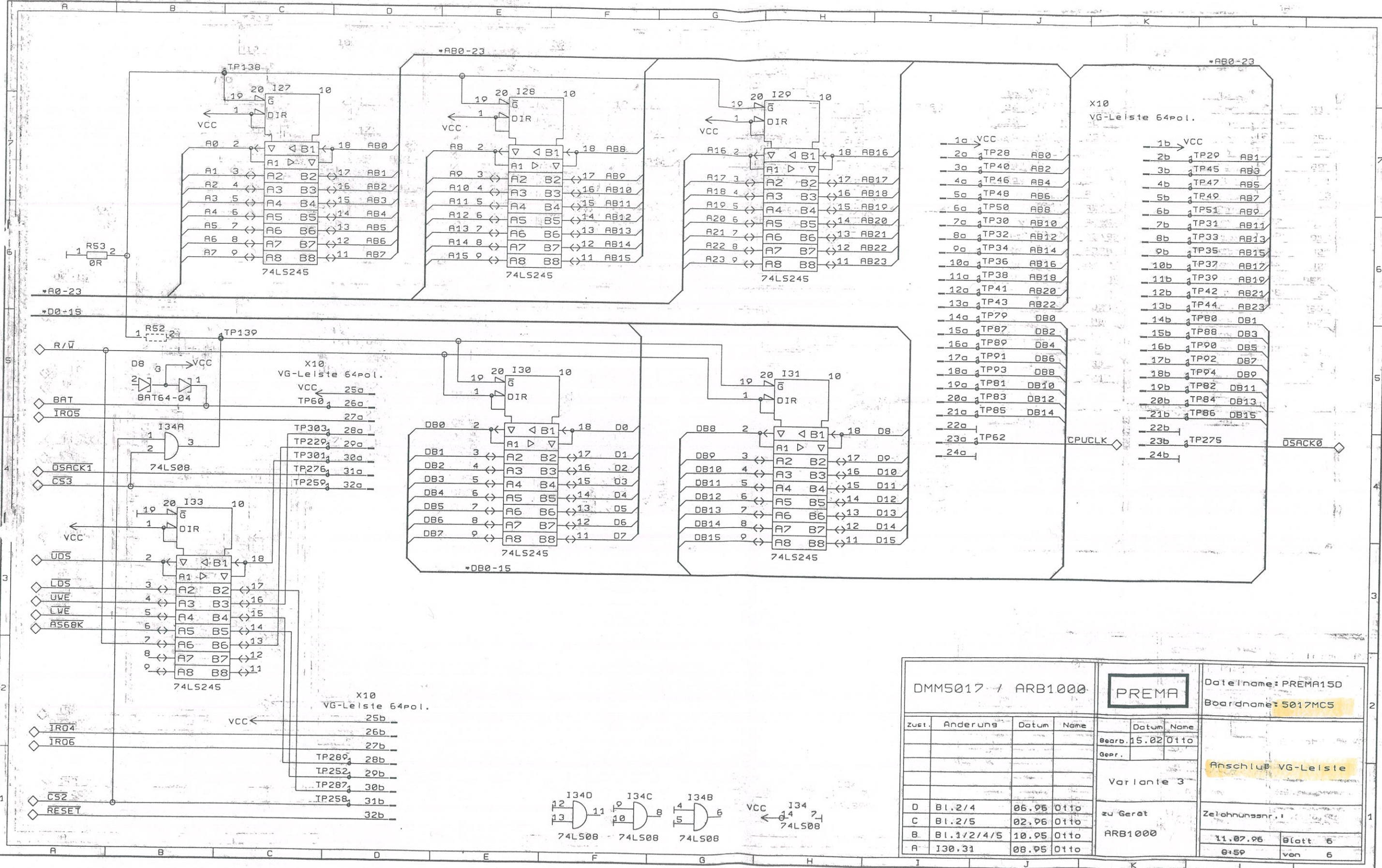

DMM5017 / ARB1000				PREMA		Dateiname: PREMA150			
						Boardname: 5017MC5			
Zust.	Anderung	Datum	Name	Datum	Name	Anschluß VG-Leiste			
				Bearb.	15.02.01			Otto	
				Gepr.					
				Variante 3					
				zu Gerät					
				ARB1000					
D	Bl. 2/4	06.95	Otto			Zeichnungsnr. 1			
C	Bl. 2/5	02.96	Otto			11.07.95 Blatt 6			
B	Bl. 1/2/4/5	10.95	Otto			0+59 von 6			
A	I30.31	08.95	Otto						