

COUPLER, BNC, TEST SET (unwired) (Part No. 011-0081-00)

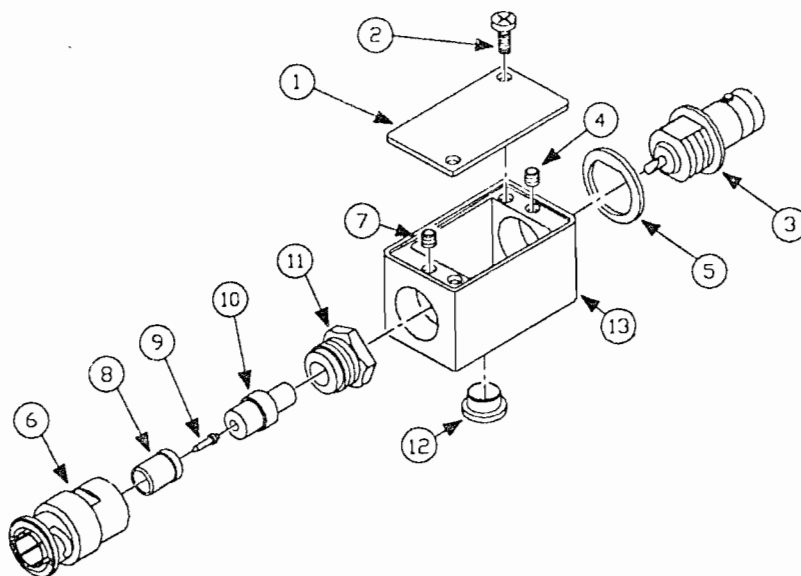

Fig. & Index No.	Tektronix Part No.	Serial/Assembly No. Effective	Discnt	Qty	12345	Name & Description	Mfr. Code	Mfr. Part No.
1-1	200-0681-00			1		COVER, COUPLER: (ATTACHING PARTS)	80009	200-0681-00
-2	213-0088-00			2		SCREW, TPG, TF: 4-24 X 0.25, TYPE B, PMH, STL (END ATTACHING PARTS)	83385	ORDER BY DESCR
-3	131-0126-00			1		CONN, RCPT, ELEC: BNC, FEMALE (ATTACHING PARTS)	24931	28JR205-2
-4	213-0075-00			1		SETSCREW: 4-40 X 0.094, STL	74445	ORDER BY DESCR
-5	210-0962-00			1		WASHER, BEVEL: 0.505 ID X 0.688 OD X 0.047 (END ATTACHING PARTS)	80009	210-0962-00
-6	134-0044-00			1		SHELL, ELEC CONN: BNC (ATTACHING PARTS)	02660	31-202-1002
-7	213-0075-00			1		SETSCREW: 4-40 X 0.094, STL (END ATTACHING PARTS)	74445	ORDER BY DESCR
-8	358-0072-00			1		INSULATOR, BSHG: 0.192 ID X 0.192 OD X 0.323	80009	358-0072-00
-9	214-0109-00			1		CONTACT, ELEC: CONN CTR CGMT	24931	C-1174
-10	166-0217-00			1		INSULATOR, BSHG: 0.101 ID X 0.312 OD X 0.625	80009	166-0217-00
-11	132-0081-00			1		BSHG, MACH THD: 0.437-28 X 0.433 HEX X 0.312, BRS SIL PL	24931	N101-2
-12	214-0271-00			1		BUTTON, PLASTIC: 0.375 DIA X 0.2 THK, DELRIN	80009	214-0271-00
-13	202-0095-00			1		HSG, STANDARDIZE: 1.5 X 0.875 X 0.812, ZAMAK	80009	202-0095-00

CROSS INDEX - MFR. CODE NUMBER TO MANUFACTURER

Mfr. Code	Manufacturer	Address	City, State, Zip Code
02660	AMPHENOL CORP COMMERCIAL AND INDUSTRIAL OPNS	4300 COMMERCE CT	LISLE IL 60532
24931	SPECIALTY CONNECTOR CO INC	2100 EARLYWOOD DR PO BOX 547	FRANKLIN IN 46131
74445	HOLO-KROME CO	31 BROOK ST	ELMWOOD CT 06110-2350
80009	TEKTRONIX INC	14150 SW KARL BRAUN DR PO BOX 500	BEAVERTON OR 97077-0001
83385	MICRODOT MFG INC GREER-CENTRAL DIV	3221 W BIG BEAVER RD	TROY MI 48098

062-0678-00
JULY 1989(R)